

Components for Distribution Boxes BL8060 Series Explosion-proof Circuit Breaker Modules

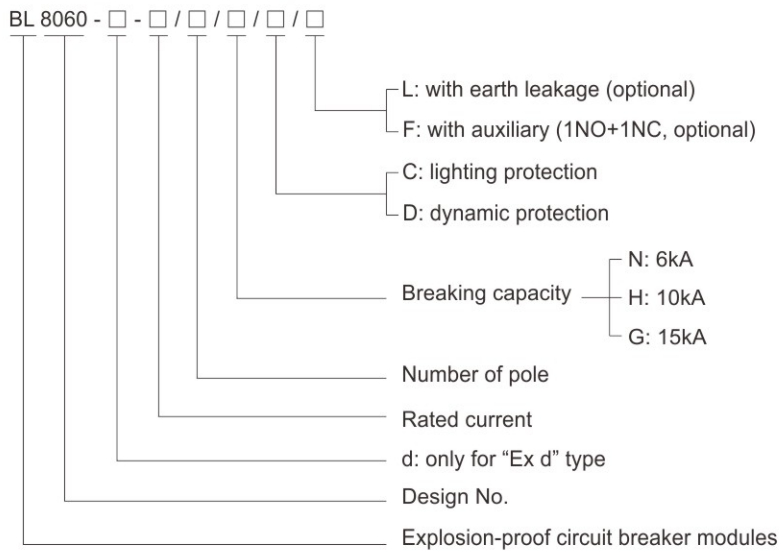

- ◆ Explosion protection to
 - CENELEC
 - IEC
 - NEC
- ◆ Can be used in
 - Zone 1 and Zone 2
 - Class I, Zone 1 and Zone 2
 - Class I, Division 2, Groups A, B, C, D
- ◆ Product of flame-proof structure; the cavity is of engineering plastic embedded with high strength metal frame structure; with strong corrosion-proof capacity and reliable performance.
- ◆ Built-in Schneider iC65 series MCB, special operation mechanism internally designed, reliable overall operation.

Catalogue number logic



Zones 1&2

Components for Distribution Boxes BL8060 Series Explosion-proof Circuit Breaker Modules

Technical data

Explosion-proof circuit breaker modules BL8060 - □ / □ / □ / □ / □ (≤ 63A)

Explosion protection	IECEX CQM 14.0031U																						
Global (IECEX)	Ex d e IIC Gb																						
Gas	EUT 14 ATEX 1301U																						
Europe (ATEX)	⊕ II 2 G Ex d e IIC Gb																						
Gas	IECEX; ATEX																						
Certificates	EN 60079-0, EN 60079-1, EN 60079-7																						
Conformity to standards	IEC 60079-0, IEC 60079-1, IEC 60079-7																						
Enclosure material	GRP (glass fibre-reinforced polyester resin)																						
Rated voltage	Max.690V AC																						
Rated current	1A, 2A, 4A, 6A, 10A, 16A, 20A, 25A, 32A, 40A, 50A, 63A																						
Rated residual operating current	30mA, 300mA, 300mA $\overline{\text{S}}$ $\overline{\text{S}}$:Under-voltage tripping(instant)																						
Rated residual current characteristics	AC, A																						
Mechanical life	20000 times																						
Auxiliary contact	1NO+1NC (indicating contact in OFF state)																						
Number of pole	1P, 2P, 3P, 4P, 1PL, 2PL																						
Ambient temperature	-20°C~+70°C																						
Breaking capacity	<table border="1"> <tr> <td>Ph.-Ph. (2P, 3P, 4P)</td> <td>12~133V</td> <td>220~240V</td> <td>380~415V</td> <td>440V</td> <td rowspan="2">Use breaking capacity</td> </tr> <tr> <td>Ph.-N (1P, 1P+N)</td> <td>12~60V</td> <td>100~133V</td> <td>220~240V</td> <td>-</td> </tr> <tr> <td rowspan="2">Rated current</td> <td>1~4A</td> <td colspan="3">6kA、10kA、15kA</td> <td>100%Icu</td> </tr> <tr> <td>6~63A</td> <td colspan="3"></td> <td>75%Icu</td> </tr> </table>	Ph.-Ph. (2P, 3P, 4P)	12~133V	220~240V	380~415V	440V	Use breaking capacity	Ph.-N (1P, 1P+N)	12~60V	100~133V	220~240V	-	Rated current	1~4A	6kA、10kA、15kA			100%Icu	6~63A				75%Icu
Ph.-Ph. (2P, 3P, 4P)	12~133V	220~240V	380~415V	440V	Use breaking capacity																		
Ph.-N (1P, 1P+N)	12~60V	100~133V	220~240V	-																			
Rated current	1~4A	6kA、10kA、15kA			100%Icu																		
	6~63A				75%Icu																		

Dimension drawings (all dimensions in mm) - subject to alteration

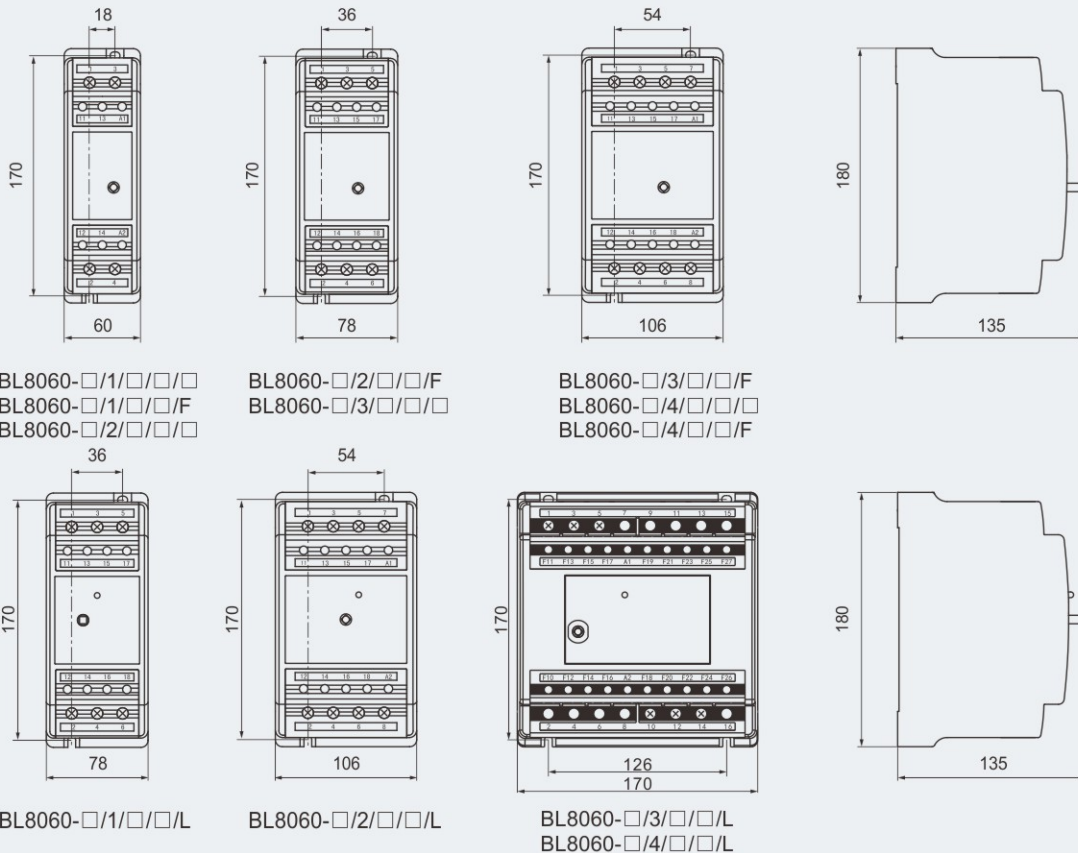

Components for Distribution Boxes BL8060 Series Explosion-proof Circuit Breaker Modules

Technical data

Explosion-proof circuit breaker modules BL8060-d - □ / □ / □ / □ / □

Explosion protection

Global (IECEX)	IECEX CQM 15.0016U
Gas	Ex db IIC Gb
Europe (ATEX)	EPT 15 ATEX 2252U
Gas	⊕ II 2 G Ex db IIC Gb

Certificates

IECEX; ATEX

Conformity to standards

EN 60079-0, EN 60079-1
IEC 60079-0, IEC 60079-1

Enclosure material

Copper-free Aluminium Alloy, powder coated surface

Rated voltage

Max.690V AC

Rated current

Max.160A

Rated residual operating current

30mA, 300mA, 300mA[Ⓢ] Ⓢ: Under-voltage tripping (instant)

Rated residual current characteristics

AC, A

Mechanical life

20000 times

Auxiliary contact

1NO+1NC (Indicating contact in OFF state)

Number of pole

1P, 2P, 3P, 4P
1PL, 2PL, 3PL, 4PL (≤ 63A)

Ambient temperature

-20°C~+70°C

Breaking capacity

		Ph.-Ph. (3P, 4P)	220~230V	380~415V	440V	500V	690V	Use breaking capacity	
Rated current	63A		20kA	10kA	6kA	-	-	75%Icu	
	80~160A		36kA						100%Icu
	100~250A			-		50kA		-	

Dimension drawings (all dimensions in mm) - subject to alteration

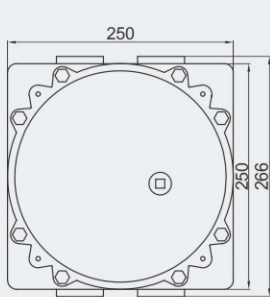

BL8060-d-□/1/□/□/□/□ L
BL8060-d-□/3/□/□/□/□ L
(≤ 63A)

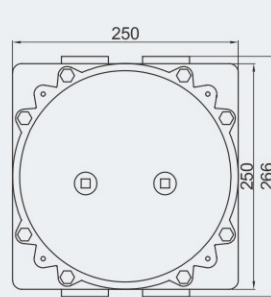
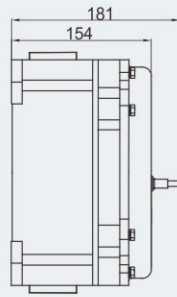

BL8060-d-□/1/□/□/□/□ L
BL8060-d-□/2/□/□/□/□ L
BL8060-d-□/3/□/□/□/□ L
BL8060-d-□/4/□/□/□/□ L
(≤ 63A)

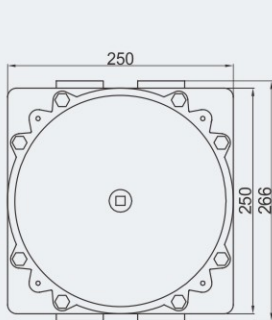

BL8060-d-□/3/□/□/□/□
BL8060-d-□/4/□/□/□/□
(80A~160A)

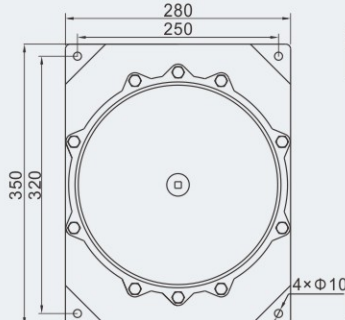
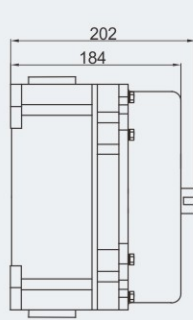

BL8060-d-□/3/□/□/□
(100A~250A)



